

Braco Double Compression Glands are manufactured out of brass rods/castings and are machined accurately to the required sizes. These are nickel plated to avoid corrosion whilst storage and use.

These glands have two moisture proof seals and may be used under most climatic conditions. These are weather proof and water proof and when protected by a PVC shroud, these can be used under most corrosive conditions. The armour cone and ring gives excellent mechanical and electrical connections.

These Glands are certified by Central Institute of Mining and Fuel Research, Dhanbad for use in Flame proof and weather proof conditions. These Glands are rated with IP protection upto IP-68 Levels.

These glands are as per BS 6121:Part 1:2005 and have parts: Brass body, Armour clamp and Ring, Gland Barrel sealing nut, two seals, check nut, check nut and flat washer between the gland barrel and check nut is provided to prevent the drag on outer seal.

These glands are available in various different sizes and are suitable for all cables up to 1000sq. mm and control cables up to 61 cores. Threads can be ET / mm /NPT as per requirement. However if any special kind of gland or thread is required, the same can be supplied on request.

The gland can also be supplied with any other special plating such as cadmium, tin or pasivated. Also the glands can be supplied made out of aluminum, mild steel or stainless steel. Can be supplied in IIA/ IIB/IIC



DOUBLE COMPRESSION BRASS GLANDS (Flame Proof)

Certified by : Central Institute of Mining & Fuel Research

BRACO CAT. No.	B	A	A/F E	A/C E1	Nipple thread Inch C			D	Acceptable cable OD (mm)	
					ET	MM	NPT		Above	Upto
					BPF-3/8'	13	11		21	24
BPF-1/2"	15	11	21	24	5/8"	M16	1/2" NPT	25	8	13
BPF-001S	14	13	21	24	3/4"	M20	1/2" NPT	25	8	13
BPF-5/8"	17	14	23	26	3/4"	M20	1/2" NPT	25	11	15
BPF-001	17	14	24	27.5	3/4"	M20	1/2" NPT	25	12.5	16.5
BPF-01S	17.5	15	25	29	3/4"	M20	1/2" NPT	25	12.5	16.5
BPF-01	20	14	27	31	3/4"	M20	1/2" NPT	25	15	18
BPF-01L	20	15	27	31	1"	M25	3/4" NPT	25	15	18
BPF-02	20.5	18	30.5	35.5	1"	M25	3/4" NPT	25	18	20
BPF-02S	20.5	14	30.5	35.5	3/4"	M20	1/2" NPT	25	18	20
BPF-03	23	18	30.5	35.5	1"	M25	3/4" NPT	25	20	23
BPF-1"	23	20	30.5	35.5	1"	M25	3/4" NPT	25	20	23
BPF-04	28	20	37	43	1"	M25	3/4" NPT	25	23	26
BPF-04L	28	24	37	43	1-1/4"	M32	1" NPT	25	23	26
BPF-05	31	25	41	47	1-1/4"	M32	1" NPT	25	26	30
BPF-05L	31	26	41	47	1-1/2"	M40	1-1/4" NPT	25	26	30
BPF-06	34	31	47	54.5	1-1/2"	M40	1-1/4" NPT	25	30	33
BPF-06S	34	24	47	54.5	1-1/4"	M32	1" NPT	25	30	33
BPF-07	39	33	51	59	1-1/2"	M40	1-1/4" NPT	25	33	37
BPF-08	43	38	54	62	2"	M50	1-1/2" NPT	25	37	41
BPF-09	47	40	56	65	2"	M50	1-1/2" NPT	25	41	46
BPF-010	53	44	66	76.5	2"	M50	1-1/2" NPT	25	46	52
BPF-010L	53	50	66	76.5	2-1/2"	M63	2" NPT	25	46	52
BPF-011	61	56	80	92	2-1/2"	M63	2" NPT	25	52	60
BPF-012	68	64	84	97	3"	M75	2-1/2" NPT	25	60	66
BPF-013S	73	67	90	104	3"	M75	2-1/2" NPT	25	66	72
BPF-013	79	75	98	113	3-1/4"	M82	3" NPT	25	72	78
BPF-014	85	78	103	119	3-1/2"	M90	3" NPT	25	78	83
BPF-015	98	91	112	129	4"	M100	3-1/2" NPT	25	83	93
BPF-016	106	104	125	144	4-1/2"	M115	4" NPT	25	93	104

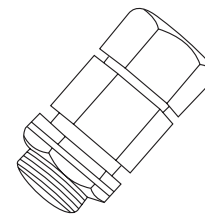

Parts

- 1. Outer Seal
- 2. Sealing Nut
- 3. Gland Body
- 4. Clamping Ring
- 5. Armour Clamp
- 6. Inner Seal
- 7. Gland Nipple
- 8. Flat Washer
- 9. Check Nut

